

# LED Bar 8w

## Multi-purpose LED Light Fitting

LED Bar - EFX-1000MLB



### LED Bar 8w - EFX-1000MLB

The Eco-FX LED Bar features patented Tri Chip technology which offers excellent thermal management and provides a life expectancy of 30,000 hours minimum. Available in various pitch options and custom lengths up to 2 metres. This dimmable LED Bar comes in red, blue, green, amber and RGB options.

Technical 8w	
Product Code	EFX-1000MLB
Size	1000mm x 28.9mm x 10.6mm
Beam Angle	120°
Input Voltage	110-265Vac
Frequency	50/60 Hz
Transformer Output	8W
Running Current	330mA
Power Factor	0.95
Chip Set	50/50 3 Chip
Efficiency (LOR)	98%
Colour Temperature	Warm White 2700-3000k Cool White 5700k
Lumen	Warm White 670lm Cool White 770lm
Efficacy	Warm White 83.75 lm/w Cool White 96.25 lm/w
CRI	Warm White >85 Cool White >80
Internal Temperature	45°
Operating Temperature	-40° / +50°
IP Rating	67
Cable	LSOH (Low Smoke Zero Halogen)



#### Eco-FX Limited

Office 1, 192 Shoreham Street  
Sheffield S1 4SQ, UK

t: +44 (0) 114 321 9610  
e: enquiries@eco-fx.co.uk

w: www.eco-fx.co.uk

Issue April 2012

©Copyright 2012 - Eco-FX Limited

### Dimensions

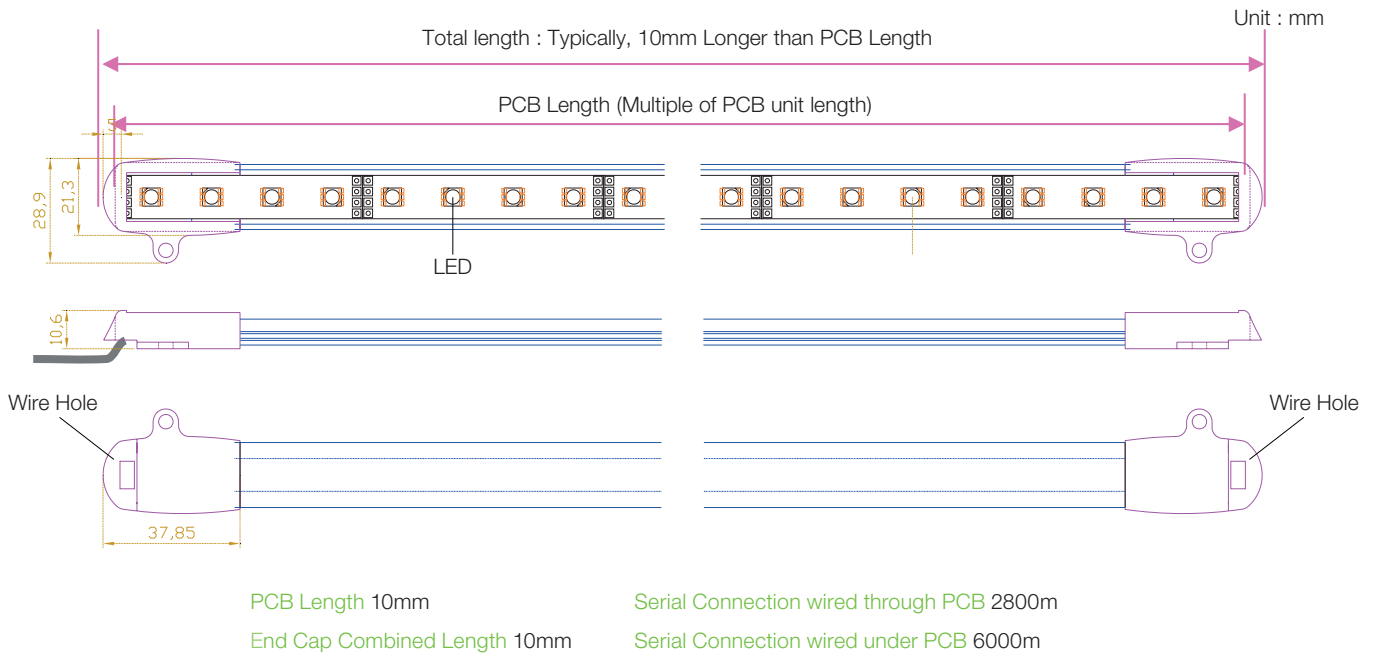

### Accessories

Adjustable Hinge for accurate LED positioning and fixing

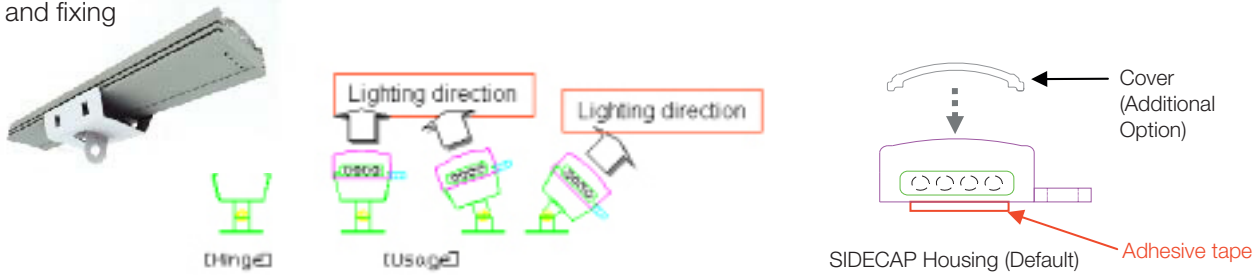

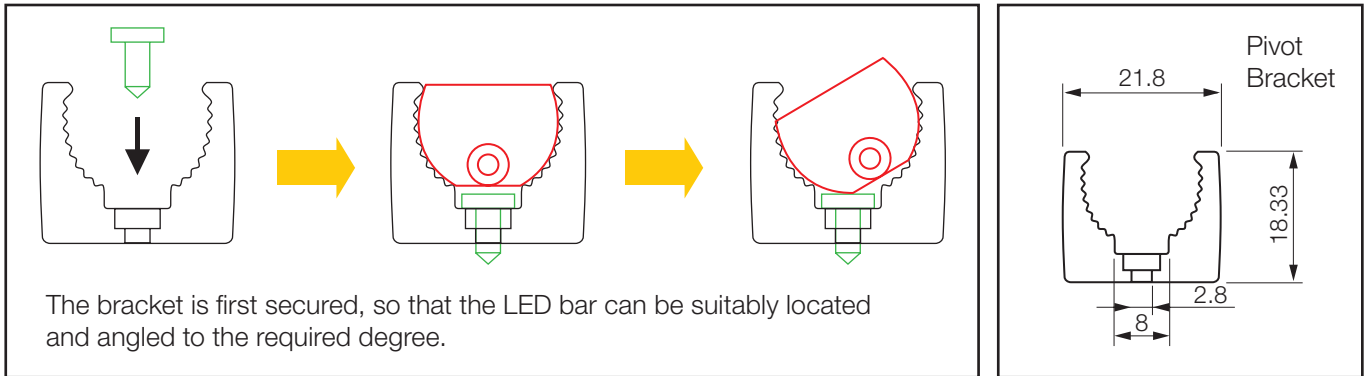

### Photometric Data

Relative brightness from the degree of the offset angle

— 1m distance  
— 2m distance

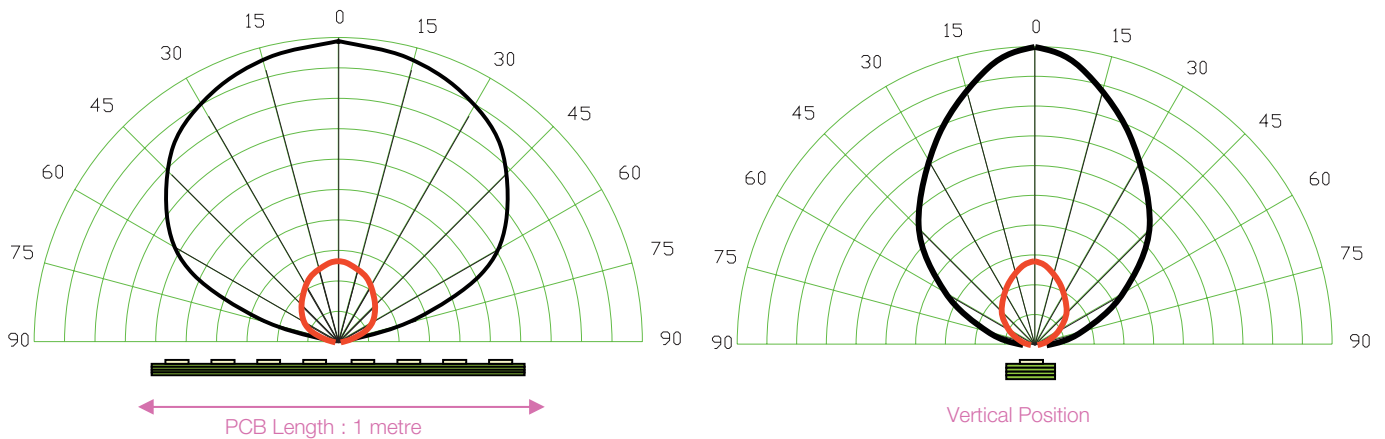

Chip LED -50/50 chip or 35/28 chip

Various levels of IP rating -up to IP67 or IP68 with additional housing.

Length of LED BAR-Is adjustable by using diferent PCB sizes.



### PVC Insulation Wire



■ **Application of Product**

- Internal Wiring of electrical and electronic equipment.

■ **Characteristics of Product**

- Rating : (UL) 300V 80°C  
(CSA) 300V 90°C
- Flammability : VW-1, FT1 Satisfaction
- Standard : UL Subject 758, 1581  
CSA C22.2 No.16
- Certification : Underwriters Laboratories Inc.(R)  
 Canadian Standard Association

■ **(Construction & Formation)**



Type	Conductor			Insulation		Max. Conductor Resistance at 20 °C (Ω/km)	Min. Insulation Resistance (Ω/km)	AC Withstand Voltage (V)	Ampacity (A)
	AWG Size	Construction	Approx. Diameter (mm)	Thickness (mm)	Diameter (mm)				
Stranded	30	7/0.102	0.31	0.4	1.15	376.96	15	2,000	2.3
	28	7/0.127	0.38		1.25	237.38			3.0
	26	7/0.160	0.48		1.35	148.94			4.0
	24	11/0.160	0.61		1.45	93.25			5.3
	22	17/0.160	0.76		1.60	55.00			7.2
	20	21/0.180	0.95		1.80	34.60			9.4
	18	34/0.180	1.21		2.00	21.80			12.5
Solid	16	26/0.260	1.53	2.40	13.70	15.9	15	2,000	2.3
	30	1/0.260	0.26	1.10	361.13	3.0			
	28	1/0.320	0.32	1.15	227.39	4.0			
	26	1/0.404	0.40	1.20	142.79	5.3			
	24	1/0.511	0.51	1.35	89.39	7.2			
	22	1/0.643	0.64	1.45	54.30	9.4			
	20	1/0.813	0.81	1.65	33.90	12.5			
TA-SC (Hiwrap)	18	1/1.024	1.02	1.85	21.40	15.9	15	2,000	3.0
	16	1/1.290	1.29	2.10	13.50	4.0			
	28	7/0.127	0.38	1.25	222.33	5.3			
	26	7/0.160	0.48	1.35	138.88	7.2			
TA-SC (Hiwrap)	24	7/0.203	0.61	1.45	85.41	9.4	15	2,000	4.0
	22	7/0.260	0.79	1.60	54.44	5.3			