

# LED Point Light Source

Applicable occasions:  
Suitable for building outline, eaves, stage, entertainment, outdoor advertising, urban landscape the adornment such as the occasion.



RGB



Single Lighting



## EFX-XJRM1 24/15/5

EFX-XJRM1 Point Light SOURCE Series, Stylish and simple design, the light use double sealed structure, it has good waterproof function. The material is high pressure die-casting aluminum, the diffuser adopts high strength PC. Adopts high efficiency and energy saving patch light source, the life time could reach 50000 hours, it is good for Environmental protection.



## EFX-XJRM1-15/24

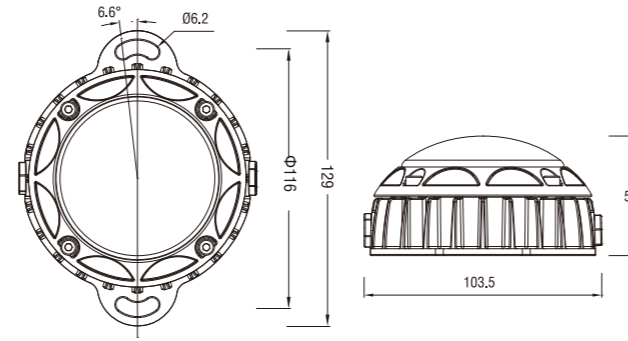

Product Size



## EFX-XJRM1-5

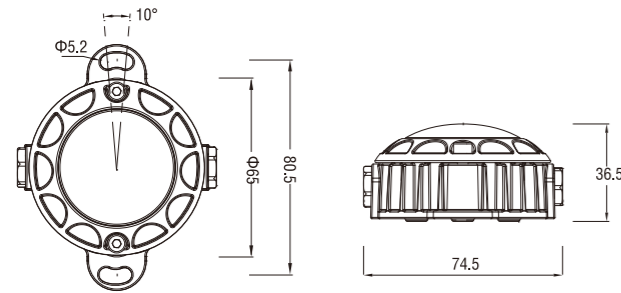

Product Size

### Light Distribution Curve

#### EFX-XJRM1-24

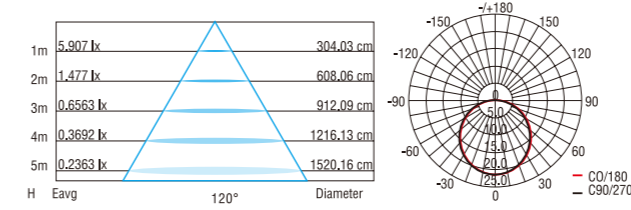

#### EFX-XJRM1-5

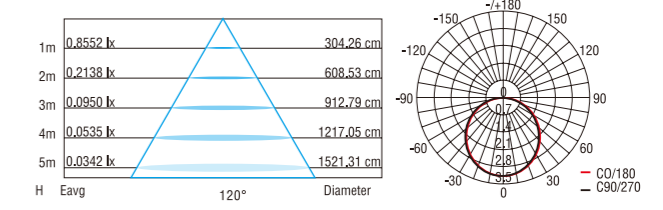

#### EFX-XJRM1-15

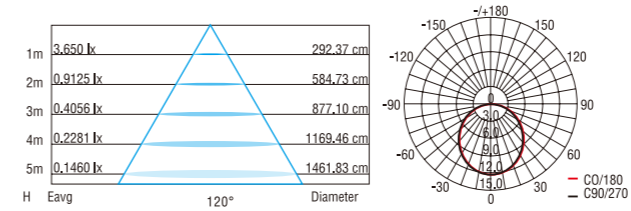

### Product Description

1. SMD5050 high brightness as the light source, long life, low power output, high heat plastic die-cast aluminum base, high uniform optical, PC light cover.
2. According to lattice combination theory, using the LED digital programmable controller computer system to realize the different types of cartoon (Gif, Flash), dot-matrix words, pictures (JPG, BMP), and various lighting effects.
3. Excellent waterproof ability.

### The Picture Of Structure Analysis

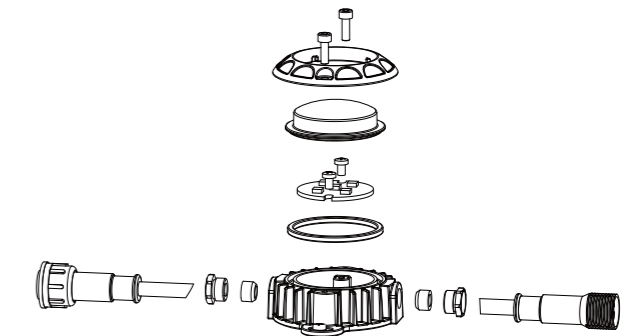

#### Application requirements:

1. The driver adopt 24V low-voltage power supply switching.
2. Installation: it needs controller, the distance between the 2 lights should be less than 1M, every 100 lamps needs a power supply, installed in the middle place.
3. Could use LED controller system.



**Wiring Diagram**

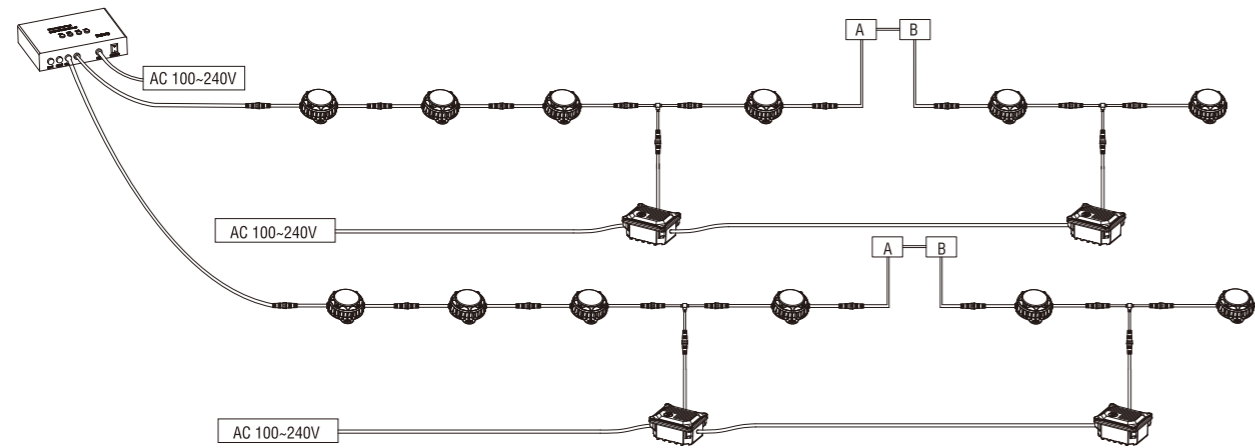

**Accessories**

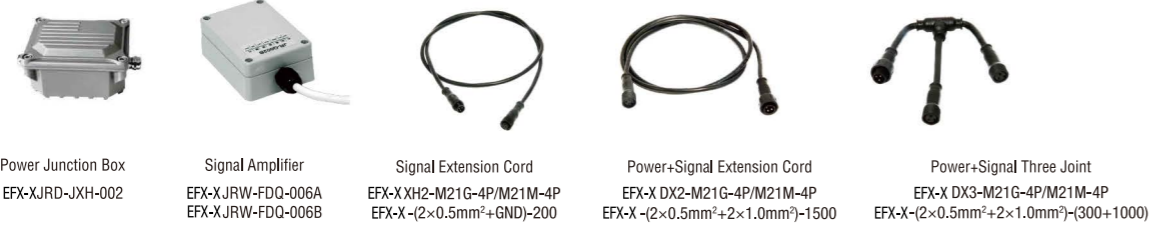

Power Junction Box  
EFX-XJRD-JXH-002

Signal Amplifier  
EFX-XJRW-FDQ-006A  
EFX-XJRW-FDQ-006B

Signal Extension Cord  
EFX-XXH2-M21G-4P/M21M-4P  
EFX-X-(2x0.5mm<sup>2</sup>+GND)-200

Power+Signal Extension Cord  
EFX-X DX2-M21G-4P/M21M-4P  
EFX-X-(2x0.5mm<sup>2</sup>+2x1.0mm<sup>2</sup>)-1500

Power+Signal Three Joint  
EFX-X DX3-M21G-4P/M21M-4P  
EFX-X-(2x0.5mm<sup>2</sup>+2x1.0mm<sup>2</sup>)-(300+1000)

**Specification**

Product Code	EFX-XJRM1-24	EFX-XJRM1-15	EFX-XJRM1-5
LED	SMD5050	SMD5050	SMD5050
LED Quantity	24 PCS	15 PCS	5 PCS
Rated Power	6W	4W	1W
Input Voltage	24V	24V	24V
Protection Grade	IP66	IP66	IP66
Color	RGB	RGB	RGB
Control Mode	DMX512/Concatenation	DMX512/Concatenation	Concatenation
Beam Angle	120°	120°	120°
Life	≥30000H	≥30000H	≥30000H
Net Weight	0.6/45	0.6/45	0.6/36
Gross Weight	0.7/52.5	0.7/52.5	0.5/45
Temperature Of Working Condition	-25°C~50°C	-25°C~50°C	-25°C~50°C
Humidity Of Working Condition	10%~90%	10%~90%	10%~90%
Packing Size (mm)	95x80x105 545x435x390 75	95x80x105 545x435x390 75	110x55x110 595x380x390 90

All parameters are measured at 25°C ambient temperature, 35% humidity experimental environment

# LED Point Light Source

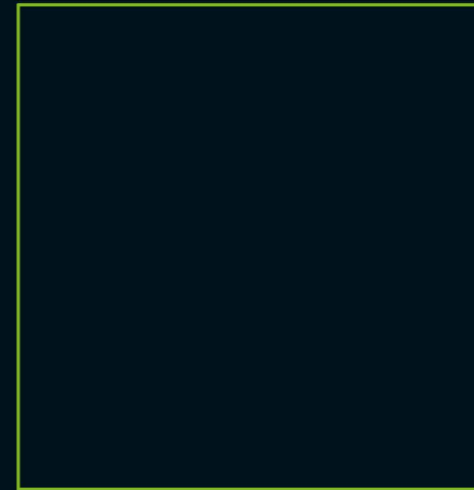

EFX-XJRX-J18

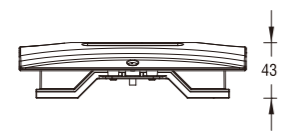
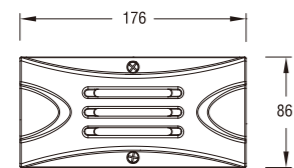

Product Size

Material and Features

1. Its covers adopt aluminum die-casting materials with plastic coating on surface.
2. The diffuser is made of PVC and the lamp house is made of high strength Die casting aluminum.
3. The lamp is made of two groups of LED lamp-houses, each of which is made of 18 pieces of Small power RGBs. The total power at normal work condition is 18w.
4. Lamp protection grade is IP66 and electric shock protection grade is Grade II.
5. Be suitable to be installed on poles, trees or walls for decoration.
6. The mounting structure of the product enables flexible installation. It may be suitable for posts of varying diameters by adding or removing the accessories.
7. Diversified control mode: The product use LED as the lamp-house, which ensures concentration of beam and overall luminance and meanwhile achieve overall and single light color change through the controller.

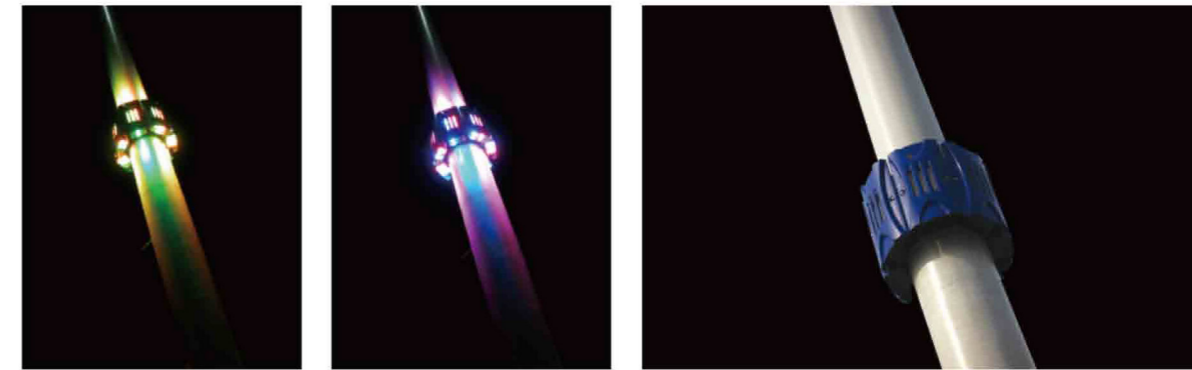

bracket1



bracket2



anchor ear

Arbitrary combinations

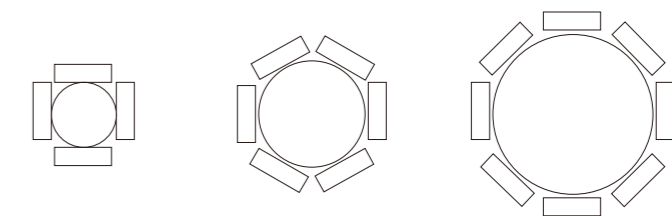

Arbitrary combinations

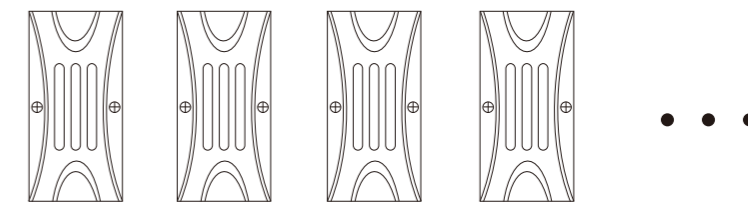

Installation

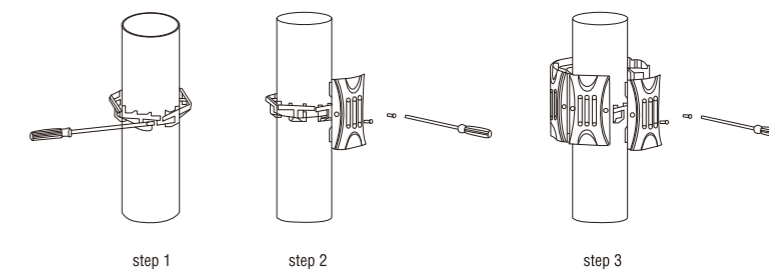



**Wiring Diagram**

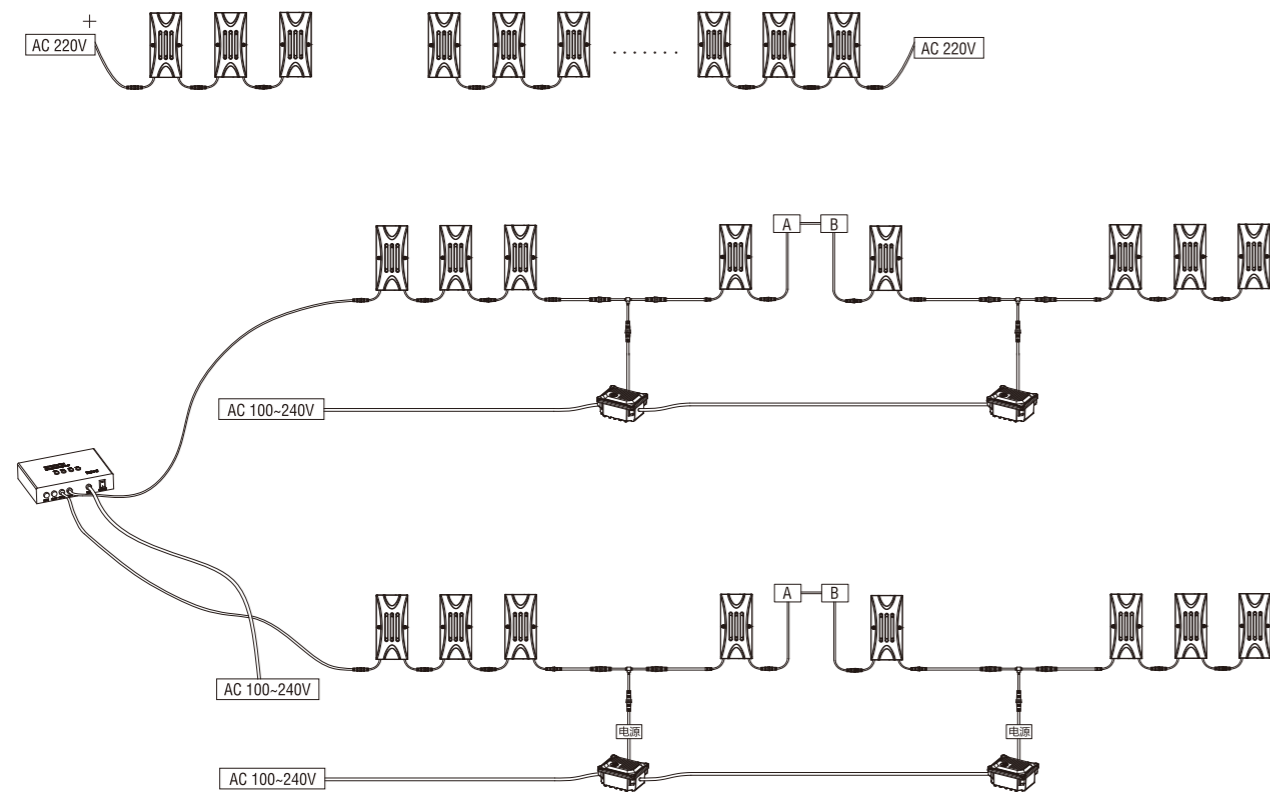

**Accessories**

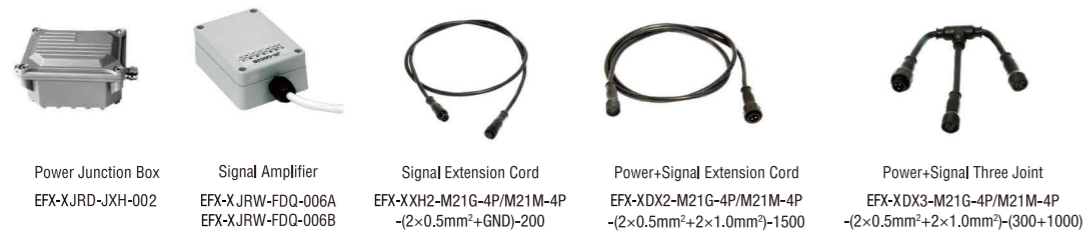

Power Junction Box EFX-XJRD-JXH-002  
 Signal Amplifier EFX-XJRW-FDQ-006A EFX-XJRW-FDQ-006B  
 Signal Extension Cord EFX-XXH2-M21G-4P/M21M-4P -(2×0.5mm<sup>2</sup>+GND)-200  
 Power+Signal Extension Cord EFX-XDX2-M21G-4P/M21M-4P -(2×0.5mm<sup>2</sup>+2×1.0mm<sup>2</sup>)-1500  
 Power+Signal Three Joint EFX-XDX3-M21G-4P/M21M-4P -(2×0.5mm<sup>2</sup>+2×1.0mm<sup>2</sup>)-(300+1000)

**Specification**

Product Code	EFX-XJRX-18/1	EFX-XJRX-18/4	EFX-XJRX-18/6
LED Quantity	16R+16G+16B	64R+64G+64B	96R+96G+96B
Module Quantity	1 PCS	4 PCS	6 PCS
Total Power	MAX 2.5W	MAX 10W	MAX 15W
Net Weight	0.3/16.8	1.5	2.25
Gross Weight	0.4/22.4	1.8	2.6
Power Mode	AC100-240V 50/60Hz & DC12V		
Temperature of Working Condition	-25°C~50°C		
Humidity of Working Condition	10%~90%		
Life	>30000H		
Protection Grade	IP66		
Installation mode	Be suitable to be installed on poles, trees or walls for decoration		
Changing mode	Seven-color jump, graded, happy valley, and other changes		
Packing Size(mm)	180×90×55 405×395×460 56		

All parameters are measured at 25°C ambient temperature, 35% humidity experimental environment

# LED Point Light Source

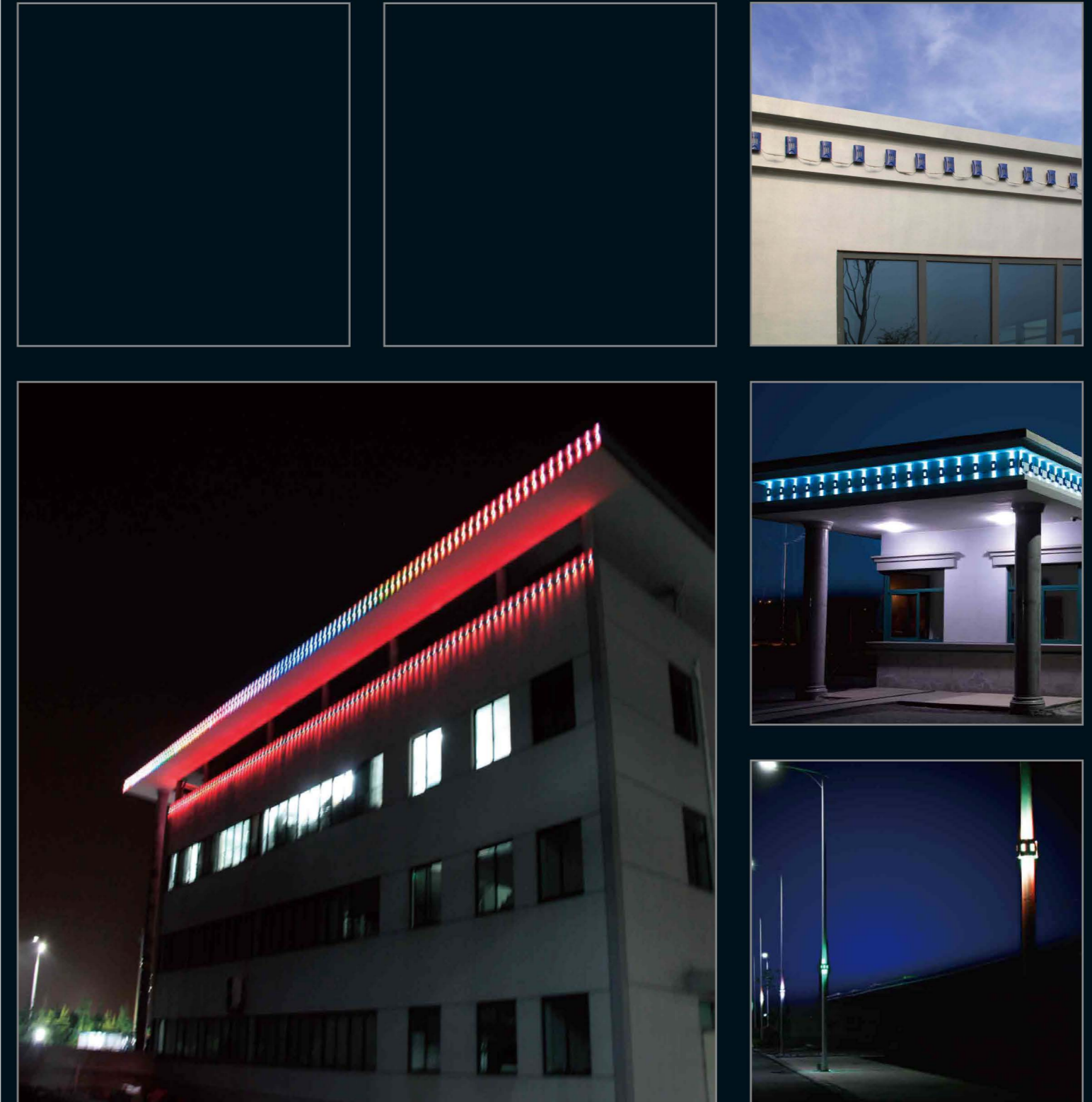

[www.eco-fx.co.uk](http://www.eco-fx.co.uk)

**EcoFX**  
LED lighting solutions

Office 1, 192 Shoreham Street  
Sheffield S1 4SQ, UK  
**T: +44(0) 114 321 9610**  
**E: [enquiries@eco-fx.co.uk](mailto:enquiries@eco-fx.co.uk)**

Global Partner

**Eco-FX**  
Smarter LED Lighting Solutions  
Australia

