

EFX-SCFTN85NW

Description:

This product use durable long life span LED as light source, smooth light without glare, simple looking design. Corrosion-proof, water-proof and dust-proof, IP rating is up to IP65, can be used in different environment. Use aluminum alloy and PC as the material which ensures that it can work stably in different environment. Life Span: 50,000 Hours.



Dimensions(Unit:mm):

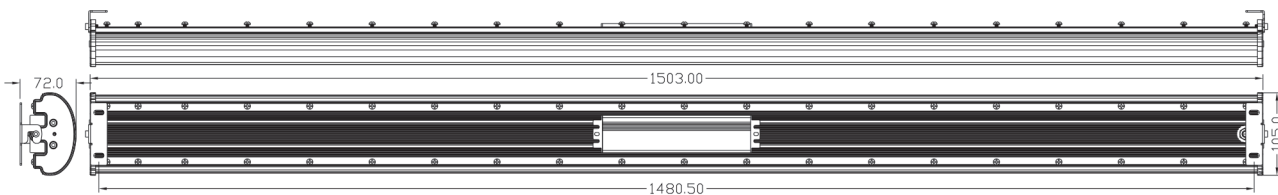

Specification:

Color	LED Type /Quantity	Light Output (lumen)	Beam Angle (degrees)	CCT	CRI	Max.Current (Amps)	Power (W)	Voltage	PF	Net Weight	Gross Weight
White	SMD 3528 LED (924PCS)	6120	230	5500-7000K	80	1	80	AC 100-240V 50/60Hz	≥0.9	3.5	3.75
Natural white		6390	230	4000K-4500K	80						
warm white		5500	230	2700-3200K	82						

Structure diagram:

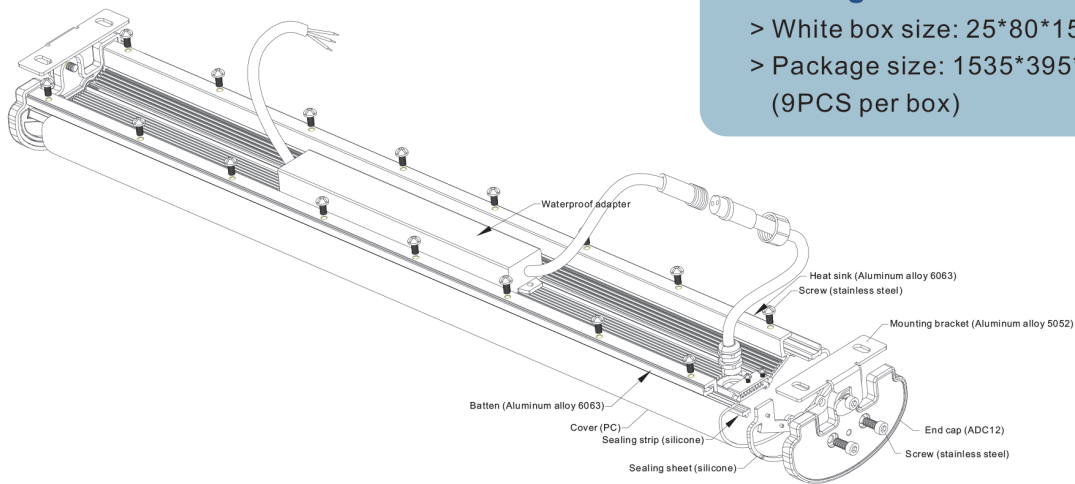

Package Information:

- > White box size: 25*80*1520mm
- > Package size: 1535*395*265mm (9PCS per box)

Installation information:

1. First set up accessories and fittings of the light.
2. Cut off the power before installation.
3. Make sure the product is fixed tightly to the installation surface (install it according to diagram as below).
4. Connect the wire of the light to the power supply, then switch on the power.

Installation Method I

Size: (mm)



1. Drill 4 holes of 8mm diameter.

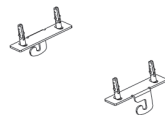

2. Install the holder on the wall, be attention that the direction should be the same.

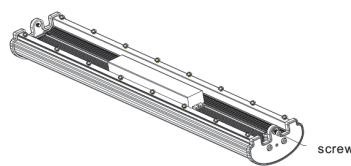

3. Turning the screw but not tightly, leave 3-4mm space.

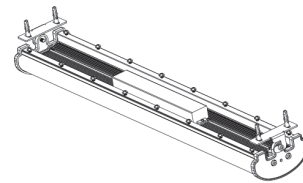

4. Install the light and tighten the screw.

Installation Method II

Size: (mm)

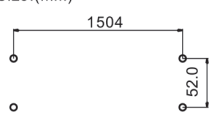

1. Drill 4 holes of 6.5mm.

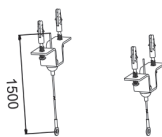

2. Install the clip onto the wall.

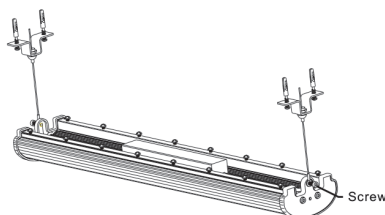

3. Use screws to connect the hanging ring with screw holes on both sides of the lamp.

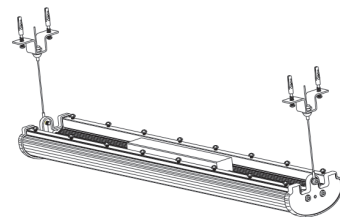

4. Adjust the height of the wires of both sides.

Other Cautions:

1. This product must be installed by professional personnels.
2. Use environment: -20°C to 45°C.
3. If there is any damage on the power line or the shell of the product, it should be taken as defective product and do not use it.
4. Dangerous high voltage, non-professionals are not allowed to maintain the product.